

ALYA DENTAL LED LIGHT

FARO DENTAL LIGHTING SYSTEMS



FARO S.p.A. has always worked together with **Research Institutes, Universities and Opinion Leaders** in order to develop dental lighting systems that might meet the physicians and patients' real needs.

FARO lamps are properly designed to offer a **great uniform shadowless illuminating effect, high colour rendering and luminous efficiency**, with **constant colour temperature** at each level of **intensity control**. With ALYA lamp, FARO sets a new reference to **state**

of the art of LED technology, the present and the future of shadowless and uniformity of lighting for dental medical use.

ALYA is entirely made in Italy with Italian technology, thanks to the ongoing commitment of all the people who works together to provide an excellent product. **ALYA** is the lamp designed for the **needs of the doctor and patients**. High technology and attractive design make it a perfect synthesis of functionality and aesthetics.

Thanks to a wide range of accessories, ALYA is available in **DENTAL UNIT-MOUNTING, WALL-MOUNTING, CEILING-MOUNTING** and **FREE-STANDING** versions.

- **OPTICAL SYSTEM PATENT N. EP 1847762**
- **3-D OPTICAL AXIS ROTATION PATENT N. EP 1847762**
- **REGISTERED COMMUNITY DESIGN N. 0001780834-0001**

TECHNICAL SPECIFICATIONS

GENERAL SPECIFICATIONS*	
Power Supply with transformer	230 Vac +/- 10% - 50/60 Hz
Power Supply with/without power supply unit	90-264 Vac - 47-63Hz / 17-24 Vac - 50-60 Hz 22-35 Vdc
Power consumption	max 26 VA
Color Temperature	5,000 K
Lux	from 3,000 to 50,000 (at 700 mm distance)
Light spot dimension	205 x 100 mm (at 700 mm distance)
Cooling System	tactical heat sink (no fan required)

Medical Device compliant with Directive 93/42/EEC, as amended - Medical devices - class I - Standard applied: EN 60601-1, EN 60601-1-2, EN 62471; Warranty 24 month
* (The technical data specified refer to typical values subject to tolerance)

FARO S.p.A. founded in 1948 by Osvaldo Favonio, designs and manufactures equipment for dental units, dental practices and dental labs. Manufacturing, design, research & development, all take place in our over 5,000 square metre plant in Ornago (MB), Italy.

Over the years, the company has become a world leader in this specific sector: a role gained by commitment to technology, research and design and an ability to understand the real needs of end users.

Utmost quality is assured by the internal management of the whole manufacturing cycle and a qualified and efficient pre and after-sales service. FARO experience best expresses the pride of a product made entirely in Italy.

The **six product lines** that manufacture and market offer a **comprehensive choice of solutions** for equipping dental practices and laboratories.



ILLUMINATION

LED AND HALOGEN

includes several models of lamp, made with LED and HALOGEN technology;



APPLICATION SETS

AND ACCESSORIES

essential for mounting the lights and their accessories to the dental unit and within the practice;



STERILIZATION

AND PACKAGING

includes class B autoclaves, distillers and sealing machines;



INSTRUMENTS

FOR DENTAL CABINETS

turbines, syringes, contra-angles and handpieces;



COMPONENTS

FOR DENTAL UNITS

a range of accessories and parts dedicated to dental units;



INSTRUMENTS

FOR LABORATORIES

motors and handpieces;

We can also customize our products to meet specific requests. For a customization project please contact our Customer Service.



EXPERIENCE AND INNOVATION
SINCE 1948

FARO S.p.A.

via Faro, 15 - 20876 Ornago (MB) - Italy Tel. +39 039.68781 - Fax +39 039.6010540
www.faro.it - export@faro.it

FARO FRANCE

Za Tgv Coriolis - 71210 Montchanin - France Tel. +33 385.779680 - Fax +33 385.779688
www.farofrance.com - farofrance@farofrance.com

FARO DEUTSCHLAND GMBH

Gewerbepark Heideckhof Heideckstr. 179 D-47805 Krefeld - Germany Tel. +49 2151.936921 - Fax +49 2151.936933
www.faro.it - info@farodeutschland.de

Certified Company



ISO 9001:2008 ISO 13485:2003

INFO LINE:



AW300000_REV19_ENG



LED
TECH



ALYA DENTAL LED LIGHT



Medical Device compliant
with Directive 93/42/EEC
FARO S.p.A. Via Faro, 15
20876 Ornago (Italy)



EXPERIENCE AND INNOVATION
SINCE 1948

ARTIFICIAL LIGHT NEVER BEEN SO SIMILAR TO SUN LIGHT

In order to achieve the best results under safety and health conditions, dentists need to operate in a **clear view** environment.

Given its composition, it has been verified that **sunlight** would be the best lighting source ever, since it allows the perceptions of every small detail in objects and figures, as well as a perfect rendering of colours. An **artificial light that is qualitatively similar to that of the sun** would be the ideal solution to allow dentists to get a clear view and facilitate their job.

What is the sunlight spectrum?

The white light that penetrates the human eye is composed of a mix of wavelengths that are at the root of colours perception. The entire field of wavelengths is called "spectrum".

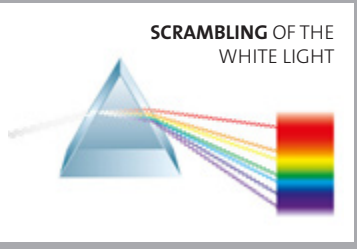

SCRAMBLING OF THE WHITE LIGHT

The spectrum of the sun shows a homogeneous distribution of wavelengths, allowing a clear and real vision of what surrounds us, whereas the most common LED lighting sources are today characterised by a discontinuous spectrum that cannot guarantee the same sunlight quality.

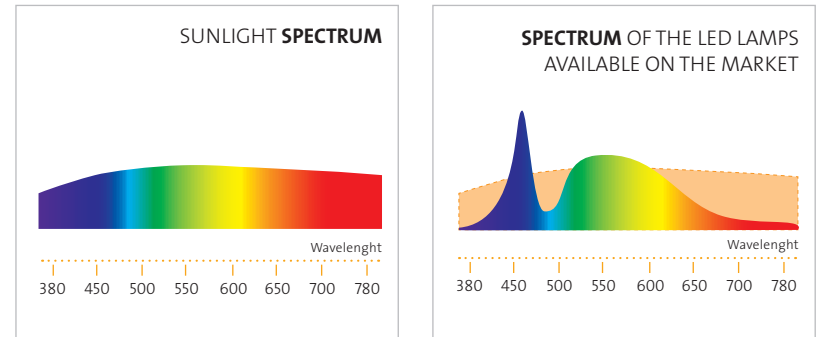

SPECTRUM OF THE NEW ALYA LAMP

The new **Alya lamp** reproduces the sun spectrum up to 95%, allowing to **pick out the tiny details of the surgical field** with minimal effort and ensuring a **proper determination of the colouring**.

CRI 97

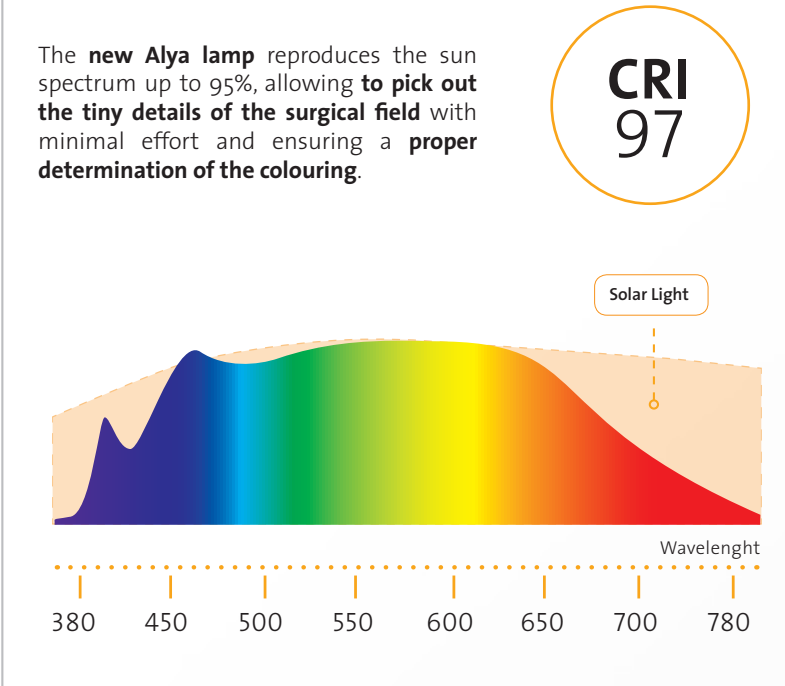

Solar Light



ALYA DENTAL LED LIGHT

24 MONTH WARRANTY

Light control by means of handy joystick or motion sensor.

Removable handles, suitable for autoclave

Suitable for any lighting requirements.

The continuous adjustment of luminous intensity enables selecting the optimal lighting level according to the different room lighting conditions.

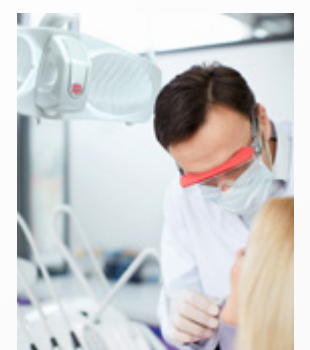

Ready for use in seconds, even after switch-off.

ALYA stores the data of last lighting level used, after turning off the dental unit and after the rinse function.

The most extensive range of lighting solutions to suit all works.

ALYA lighting level can be adjusted from **3.000 to 50.000 LUX**. A single light to work on composites and perform surgery.



Perfectly suitable for all brands of dental units.

The pins with different diameters available make possible to mount **ALYA** on dental units of different brands.



A clear and shadow free operating area.

ALYA has been designed to feature **optimal scalytic effect** reducing the shadow effect of instruments and natural barriers to a minimum.



Handy, comfortable and smooth. In any direction.

The **3-D patented rotation** system makes **ALYA** movements extremely smooth, ensuring perfect orientation.

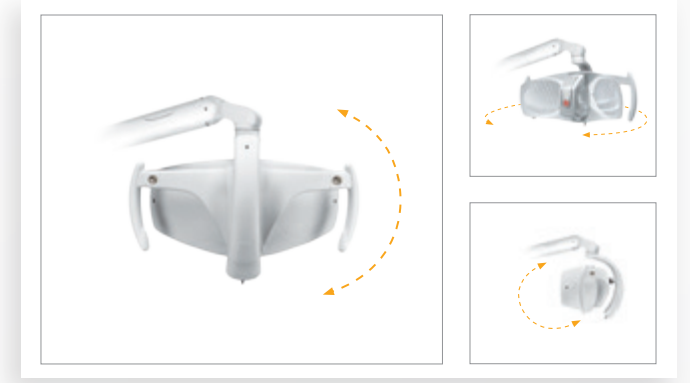

Reflected light patented optical design.

The exclusive reflected light optical design of **ALYA** ensures a **light spot of absolute evenness and high definition**, with no risk of dazzling your patients.



LED TECH



EXPERIENCE AND INNOVATION SINCE 1948

SIDÈREA DENTAL LED ROOM LIGHT

NEW

THE FIRST **FARO** ROOM LIGHT DESIGNED FOR DENTAL PRACTICES.

Always in search of the best lighting system for dental practices, FARO has designed **SIDÈREA**: the multi-directional room light that ensures an harmonious and homogeneous illumination of the workplace.

SIDÈREA is designed to interact with the dental lamp **ALYA** and the pre-operative light **THEIATECH**: the three light sources can work in sync, creating the right balance of light in the room.

A complete and integrated lighting system that allows operators to move their visual focus from one working area to the other without stressing their eyes.

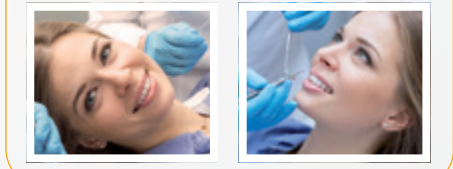

NEW

THE INNOVATIVE LED LIGHTING SYSTEM WHICH IMPROVES VISIBILITY IN THE WORKING AREA.

Patent Pending **EP16179106** - Registered Community Design: **3381425**

Integrated into the rear arm of **ALYA** dental light, **THEIATECH** improves the usability of the pre-operative surgical area, **reducing the visual stress** that the doctor undergoes during the passage from the oral cavity area (well-lighted) to the surrounding area (dimly-lighted until now).

THEIATECH was designed by FARO to work in synergy with **ALYA**: the level of illuminance of the arm is synchronized with the head light in order to ensure a **uniform illumination over the entire working area**.

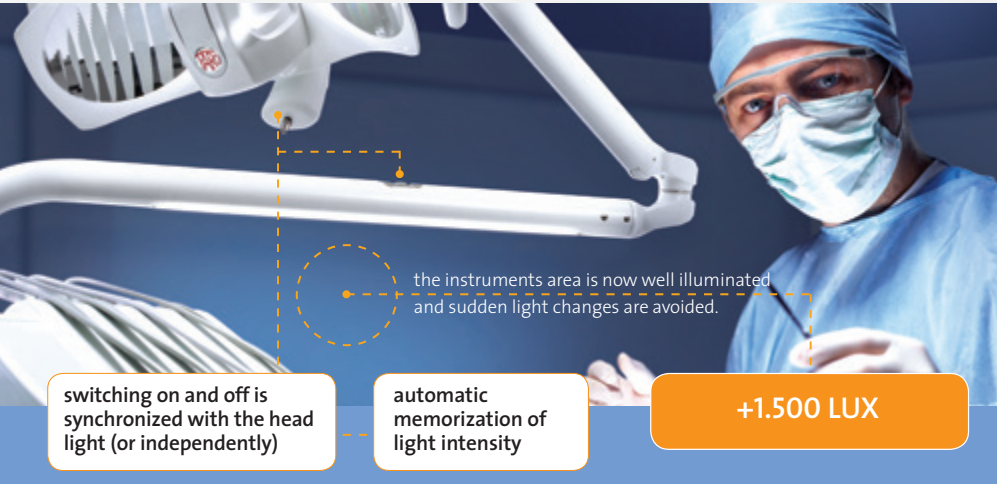

the instruments area is now well illuminated and sudden light changes are avoided.

switching on and off is synchronized with the head light (or independently)

automatic memorization of light intensity

+1.500 LUX

ALYA SCREEN

DESIGN AND FUNCTIONALITY - ALL IN ONE.

Designed specifically for the **ALYA** lamp, **ALYA SCREEN** improves communication with the patient, avoiding any contamination to the head light.

The integrated mirror improves the communication with the patient in order to:

- inform about the pathologies
- explain the therapies
- understand his expectations

The mirror can be instantly hidden by turning the front plate.

Quick and easy installation thanks to the snap-mounting with "plug and play" clips.

